

Darlot Gold Mine

Structural Capacity of Existing CIL Tank Platforms

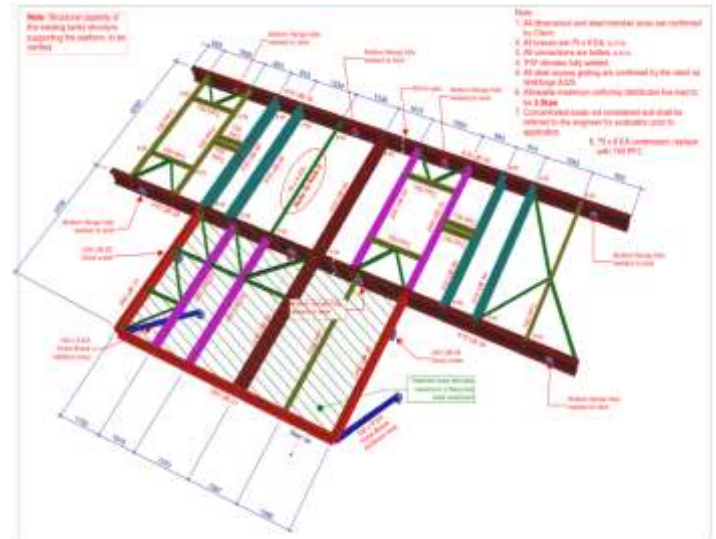
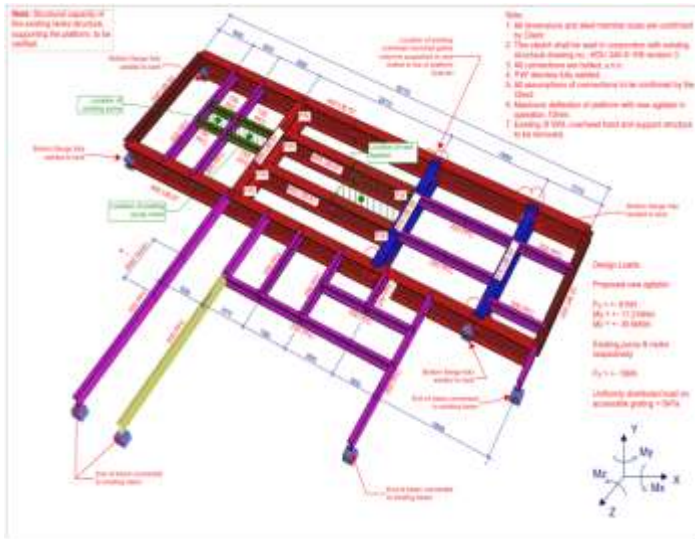

Project

CIL Tank Platforms Structural Capacity to accommodate additional loading

Location

Northern Goldfields, 57km East of Leinster, Western Australia

Client

Barrick (Australia Pacific) Limited

Commencement Date

July 2012

Practical Completion

December 2012

Description

Como Engineers were engaged to investigate the capacity of the existing CIL Tank Platforms to carry additional loading from new agitators. The new loadings were higher than previous loads and the structures had deteriorated through corrosion.

Como undertook the following Structural Engineering work:

- Inspection of the existing platforms to determine the existing members and their condition
- Modelling of the existing structures and the new loadings from the additional machines
- Specification of additional supports and bracing members, and determination of load limits to surrounding platforms
- Inspection and certification of the completed works

Project Manager

Nigel Caffyn-Parsons